

Installation instructions for PZ4AL-01927-00, PZ4AL-01928-00
Under Run Protective Shield fuel tank

SAMPLE

LEXUS GX 460

Toyota Land Cruiser 150



Model Year:	GX 460 - 2009	LC 150 Diesel - 2009	LC 150 Petrol - 2009
Vehicle Code	URJ150L-GKTZKW	KDJ15*L - G ***YW	GRJ150L - G ***KW
Part Number		Steel: PZ4AL- 01927- 00	
		Aluminium: PZ4AL- 01928- 00	



Weight

Steel: 13,49 Kg
Aluminium: 9,81 Kg



Installation Time

40min

A

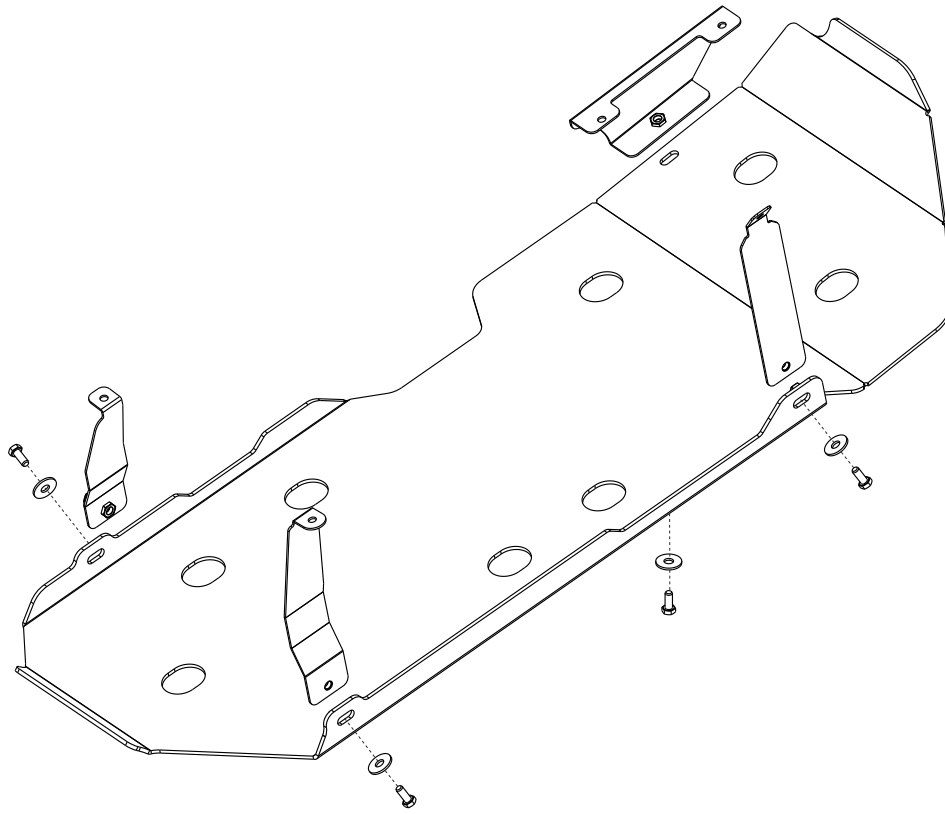

PZ4AL-01927-60

B1



1x

B2



1x

B3

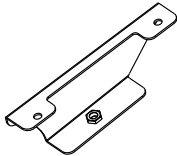

1x

B4



1x

C



M 10x20

4x

D



Ø 10

4x

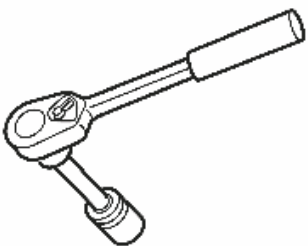

1

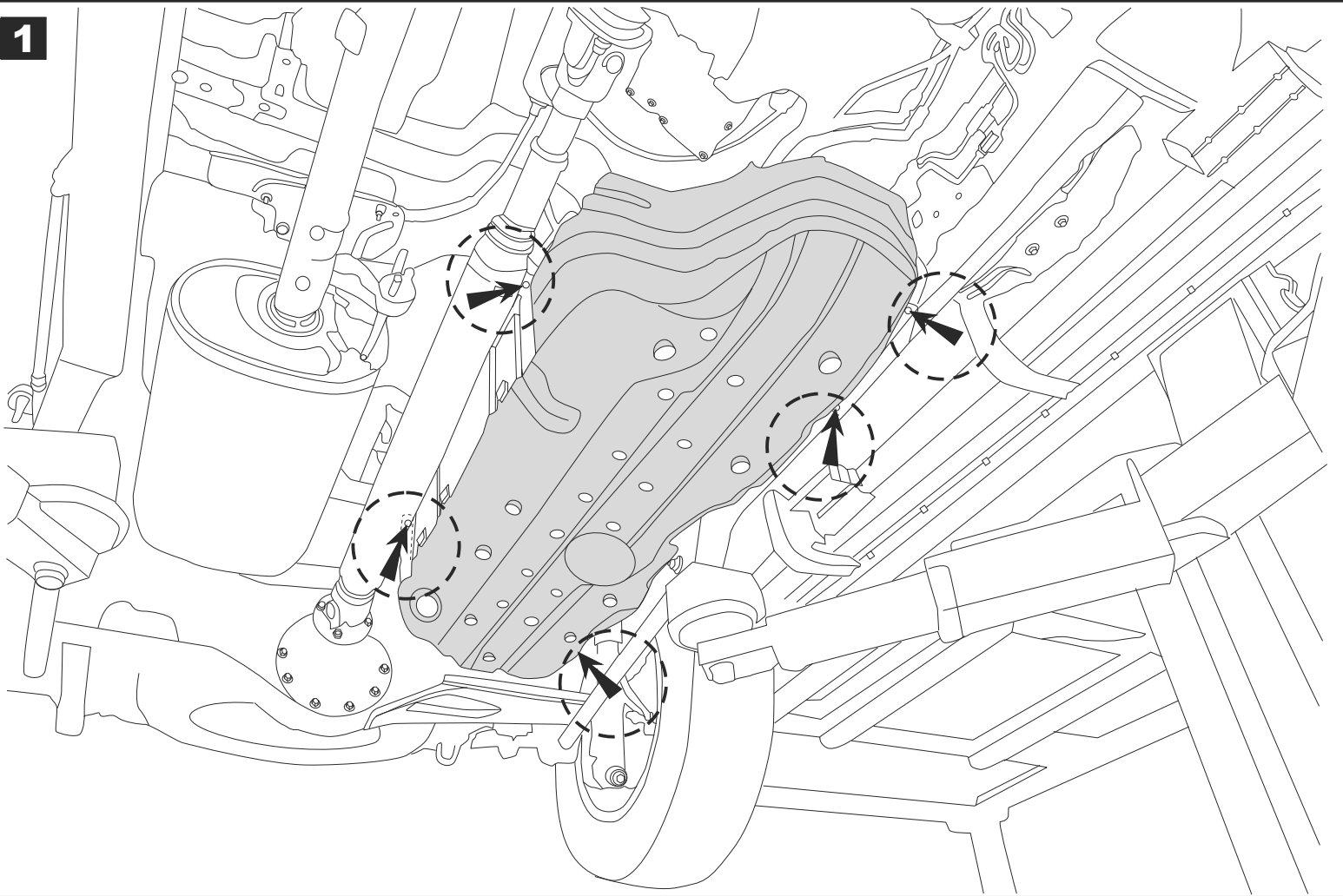

2

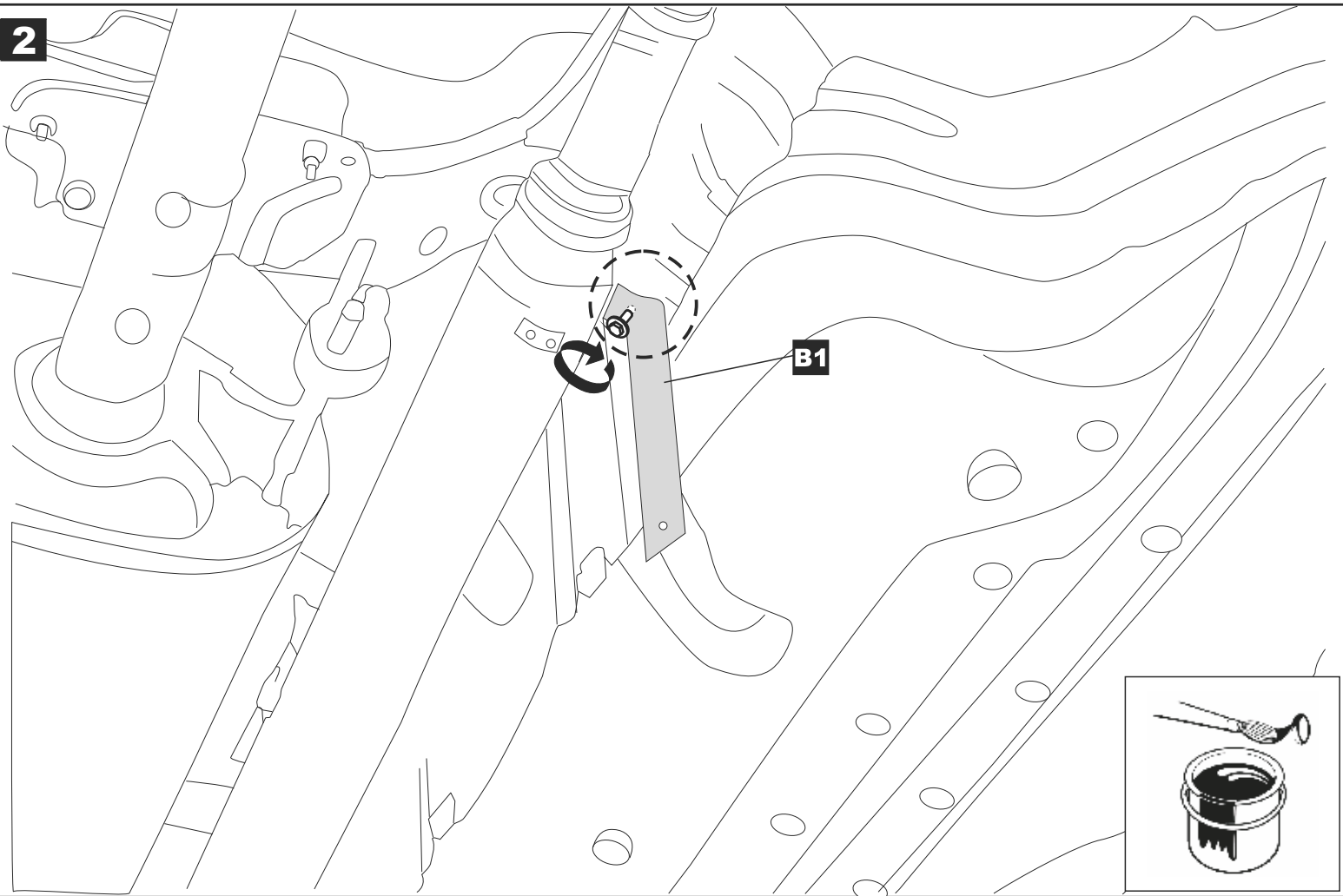

3

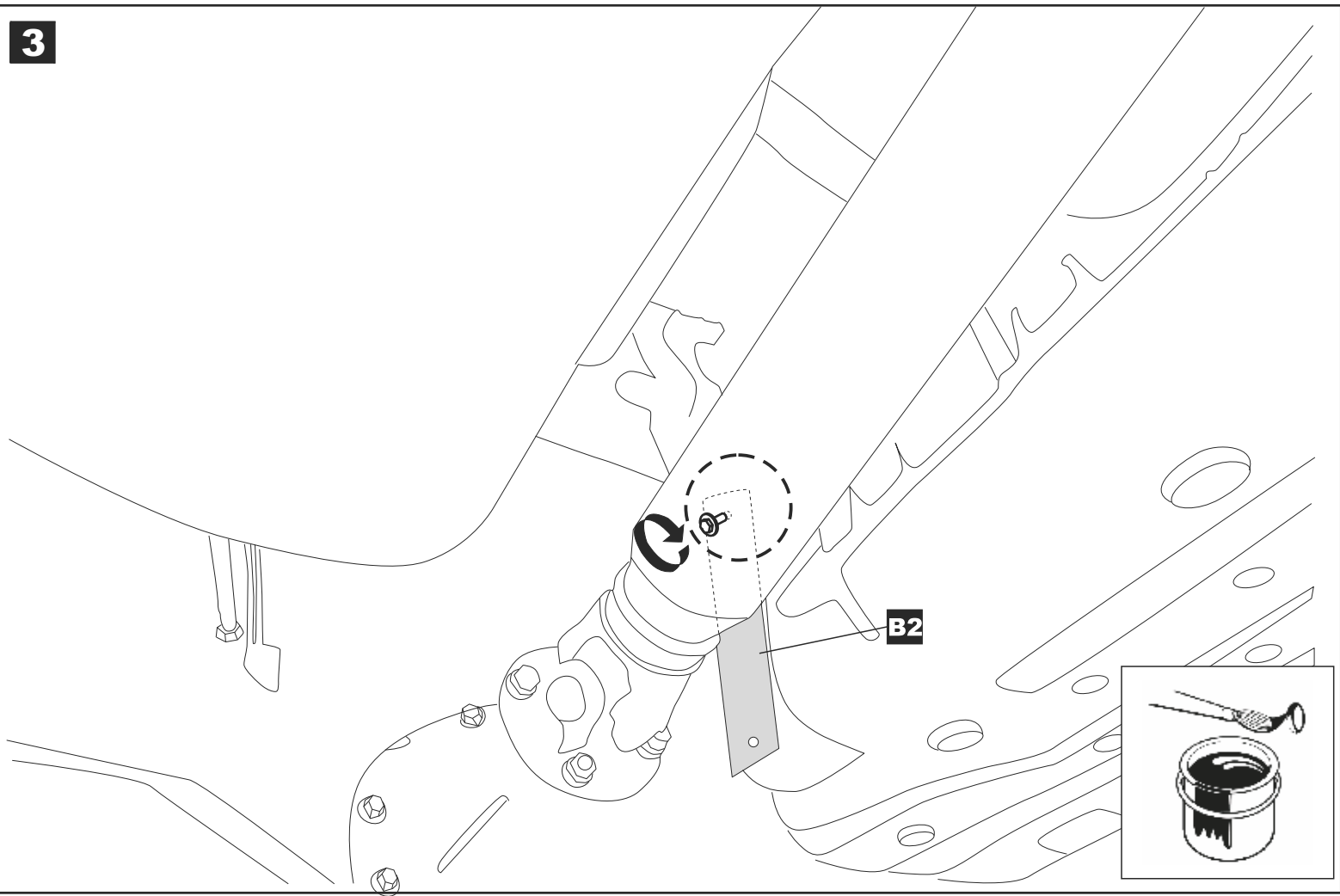

4

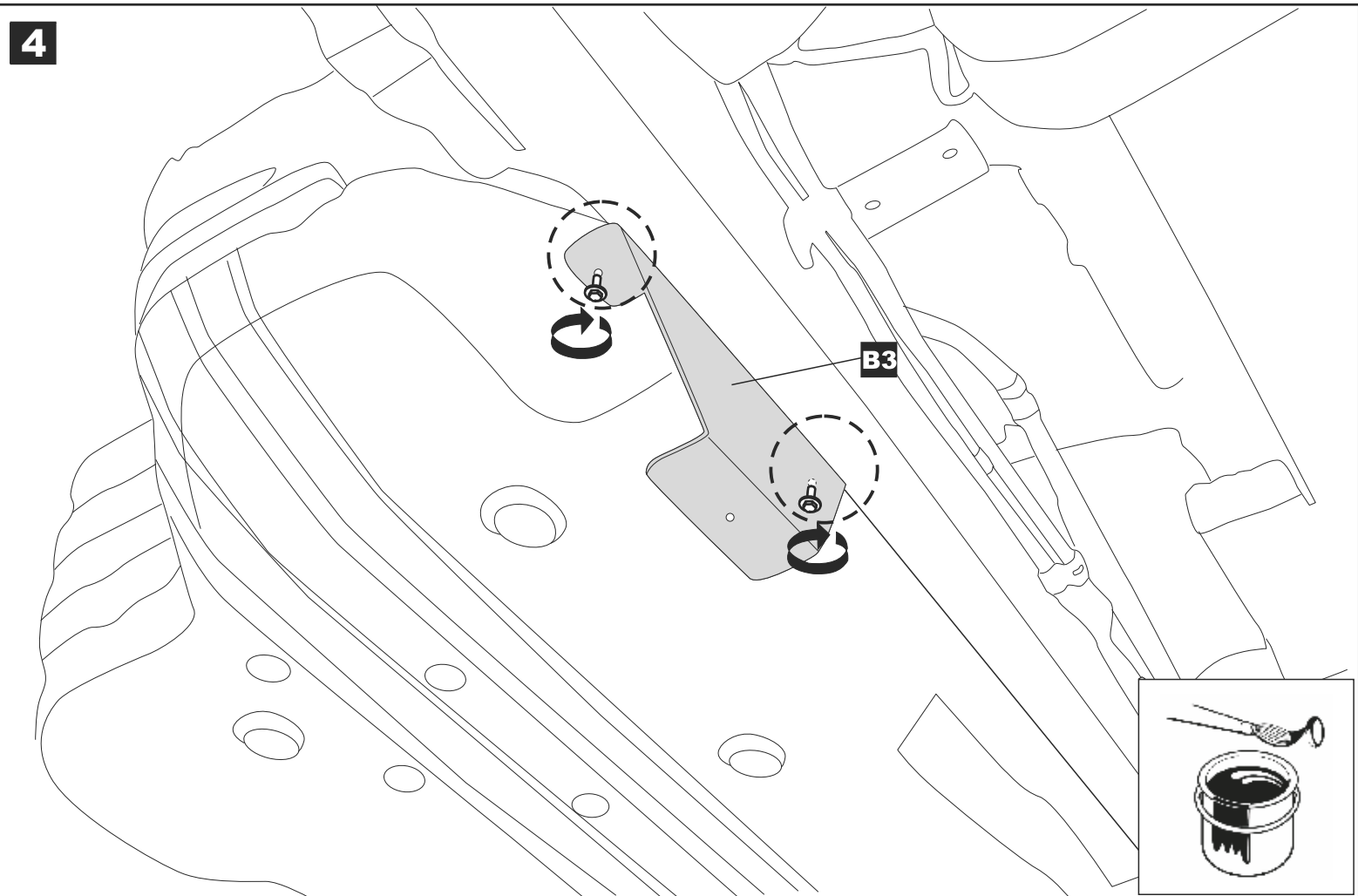

5

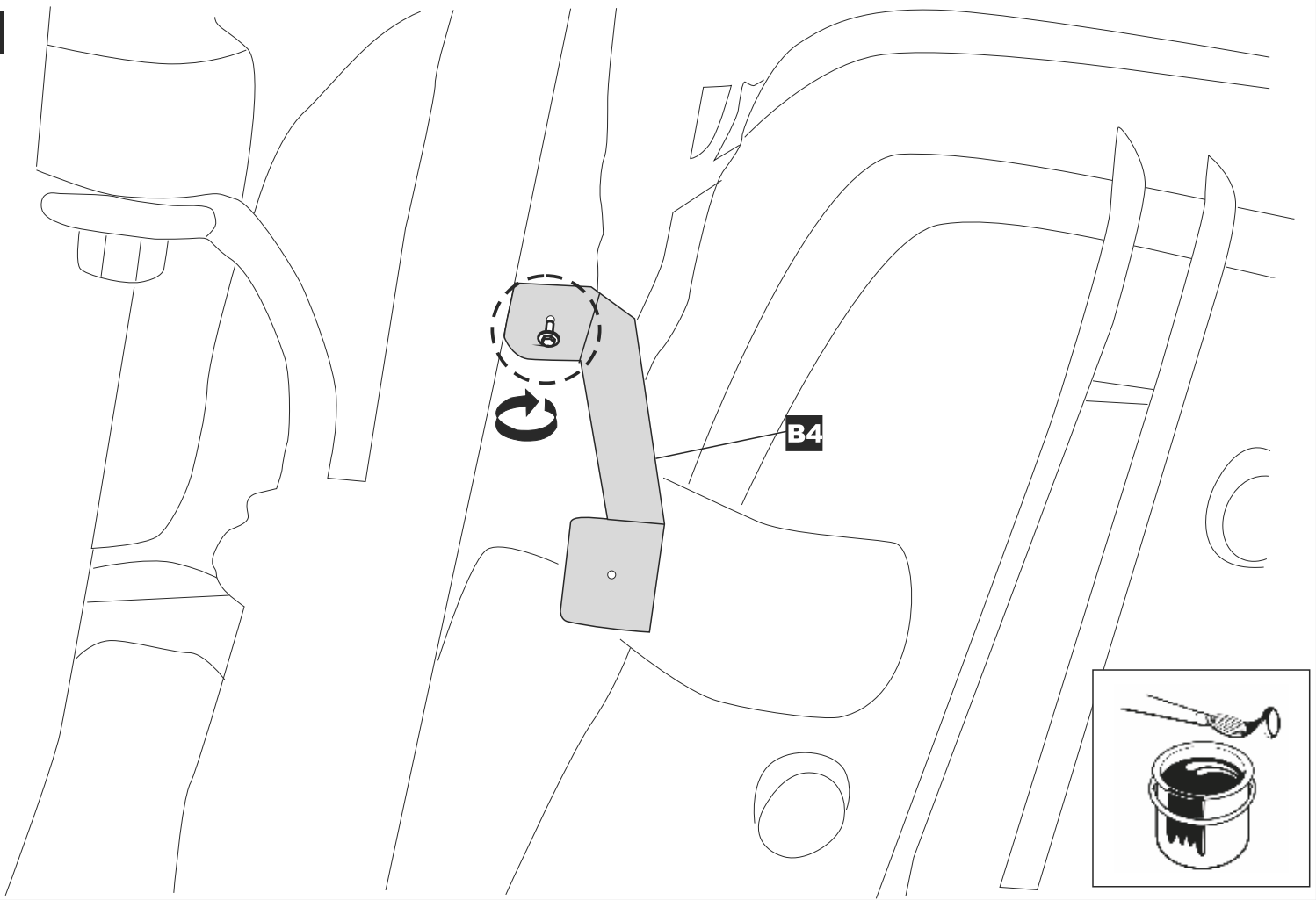

6

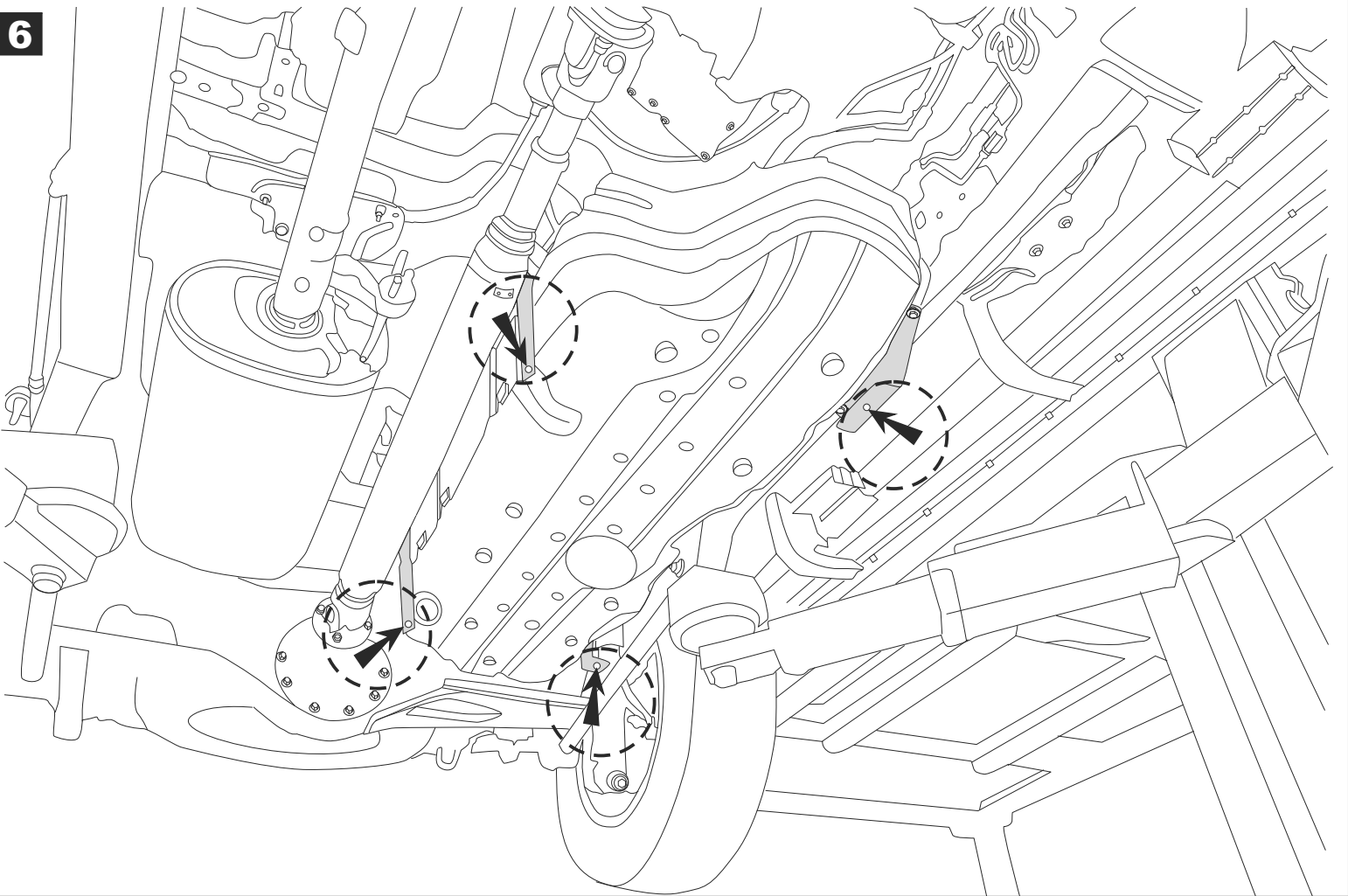

7

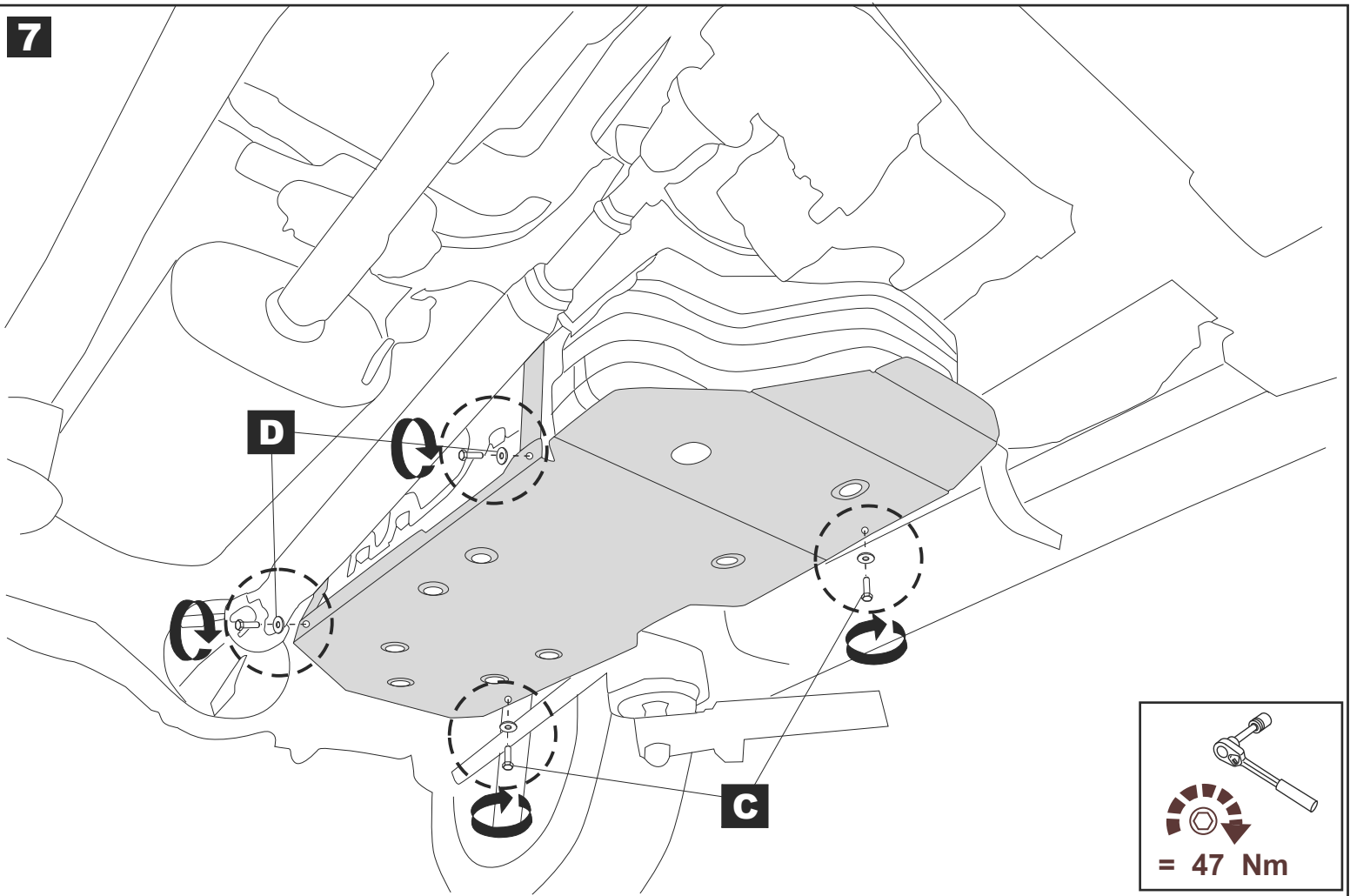

8

